



35 Spectrum Apartments Central Promenade, Douglas, Isle Of Man, IM2 4LL
Asking Price £195,000



35 Spectrum Apartments Central Promenade, Douglas, Isle Of Man, IM2 4LL

- Luxury first-floor apartment in a prestigious waterfront development on Douglas Central Promenade, enjoying scenic views over landscaped communal gardens with a tranquil water feature
- Generously sized double bedroom offering comfort and style, complemented by a versatile study or potential second reception room
- Prime location within walking distance of Douglas city centre, seafront, shops, restaurants, and excellent transport links across the Isle of Man
- Spacious lounge and dining area with private terrace access, perfectly positioned to enjoy the beautiful surroundings and peaceful garden outlook.
- Luxurious contemporary bathroom and additional separate WC, designed with modern fittings and stylish finishes throughout
- Ultra-modern open-plan fitted kitchen with high-quality fixtures, seamlessly integrated into the living space for a sleek and contemporary finish
- Secure underground allocated parking space, double glazing, electric heating, and well-maintained communal areas ensuring comfort and peace of mind



35 Spectrum Apartments Central Promenade, Douglas, Isle Of Man, IM2 4LL

Apartment 35 at Spectrum Apartments offers a rare opportunity to acquire a luxury first-floor residence within this stunning waterfront development on Douglas Central Promenade. Beautifully finished and superbly appointed throughout, the apartment features high-quality fixtures and fittings, creating an elegant and contemporary living space. The lounge and dining area open onto a private terrace, providing delightful views over the landscaped communal atrium gardens and water feature. An ultra-modern open-plan fitted kitchen complements the space perfectly, while a double bedroom offers comfort and style. The property also benefits from a study, which could serve as a second reception room, a luxurious contemporary bathroom, and a separate WC.

With electric heating, double glazing, and an allocated secure underground parking space, this apartment offers convenience and comfort in equal measure. The development provides secure access and well-maintained communal areas, enhancing both privacy and security for residents. Situated in a prime location, Douglas city centre is just a short walk away, offering an array of shops, restaurants, and leisure facilities. The picturesque seafront is also close at hand, perfect for relaxing strolls or enjoying the vibrant promenade atmosphere. Excellent transport links make travel to other parts of the island straightforward, and with no onward chain, this stylish home is ready to move into.















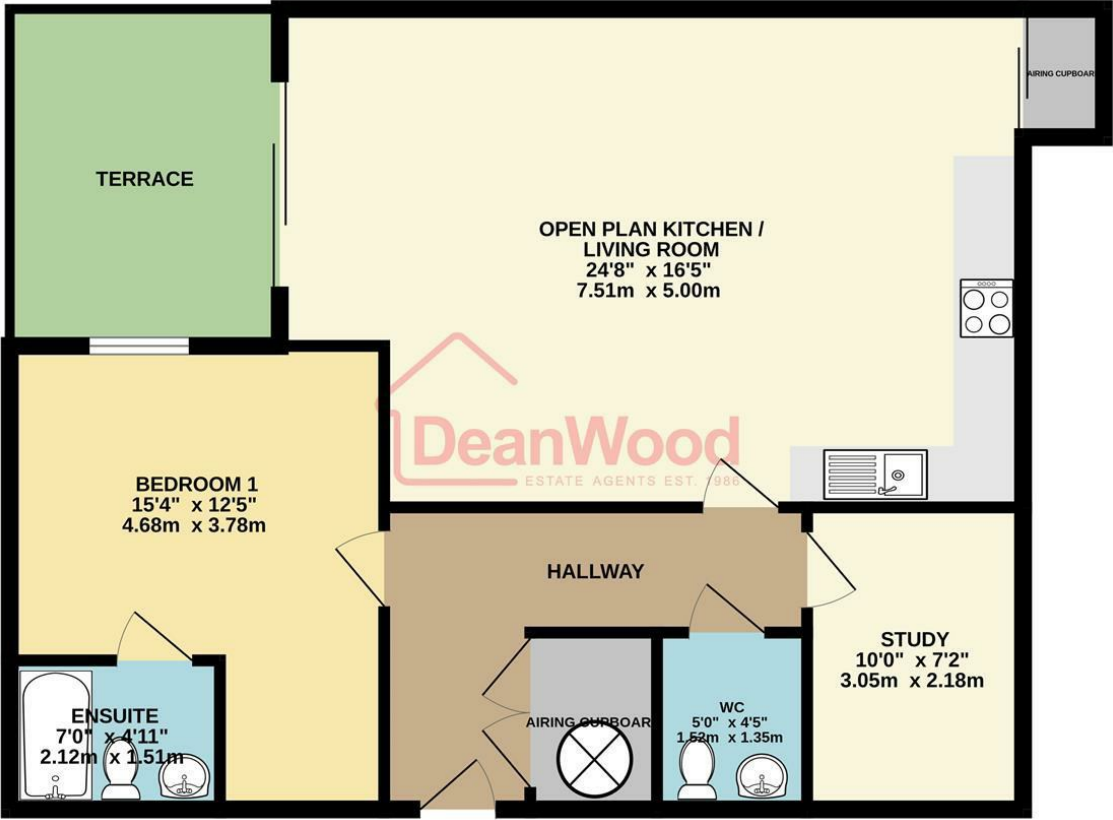

FIRST FLOOR
802 sq.ft. (74.5 sq.m.) approx.

TOTAL FLOOR AREA : 802 sq.ft. (74.5 sq.m.) approx.
Not to scale-for identification purposes only
Made with Metropix 6/2025



DOUGLAS
37 VICTORIA STREET
DOUGLAS
ISLE OF MAN IM1 2LF
T 01624 620606
F 01624 677363
E info@deanwood.co.im

CASTLETOWN
COMPTON HOUSE
9 CASTLE STREET CASTLETOWN
ISLE OF MAN IM9 1LF
T 01624 825995
F 01624 825996
E castletown@deanwood.co.im

RAMSEY
LEZAYRE HOUSE
87 PARLIAMENT STREET
RAMSEY ISLE OF MAN IM8 1AQ
T 01624 816111
F 01624 816588
E ramsey@deanwood.co.im

These particulars are for information purposes only. They do not constitute or form any contract nor should any statement contained herein be relied upon as a representation of fact. Neither the vendor nor DeanWood Agencies Limited ('the firm'), nor any officer or employee of the firm accept liability or responsibility for any statement contained herein. The vendor does not by these particulars, nor does the firm, nor does any officer or any employee of the firm have any authority to make or give any representation or warranty whatsoever as regards the property or otherwise. It is the sole responsibility of any person interested in the property described in these particulars to make all proper enquiries and searches to verify the description of the property and all other particulars herein.

FOR MORE PROPERTIES VISIT OUR WEBSITE @ **deanwood.im**